

**Key**

<b>01A</b> ADVANCED WARNING ACCESS TO ROAD AHEAD CLOSED ON ____ TO ____ FOR ____ DAY(S) FROM ____ TO ____	<b>01</b> ROAD CLOSED	<b>02</b> Divergence	<b>04</b> Diverted traffic →	<b>06</b> Diverted traffic ↑	<b>08</b> Diversion ←	<b>10</b> ROAD AHEAD CLOSED	<b>12</b> Diverted traffic ↻	<b>14</b> Diverted traffic ↻	<b>15</b> SELLERS BRIDGE CLOSED FOLLOW DIVERSION
		<b>03</b> Divergence ENDS	<b>05</b> Diverted traffic ←	<b>07</b> Diversion →	<b>09</b> Diversion ↑	<b>11</b> Diverted traffic ↻	<b>13</b> Diverted traffic ↻		

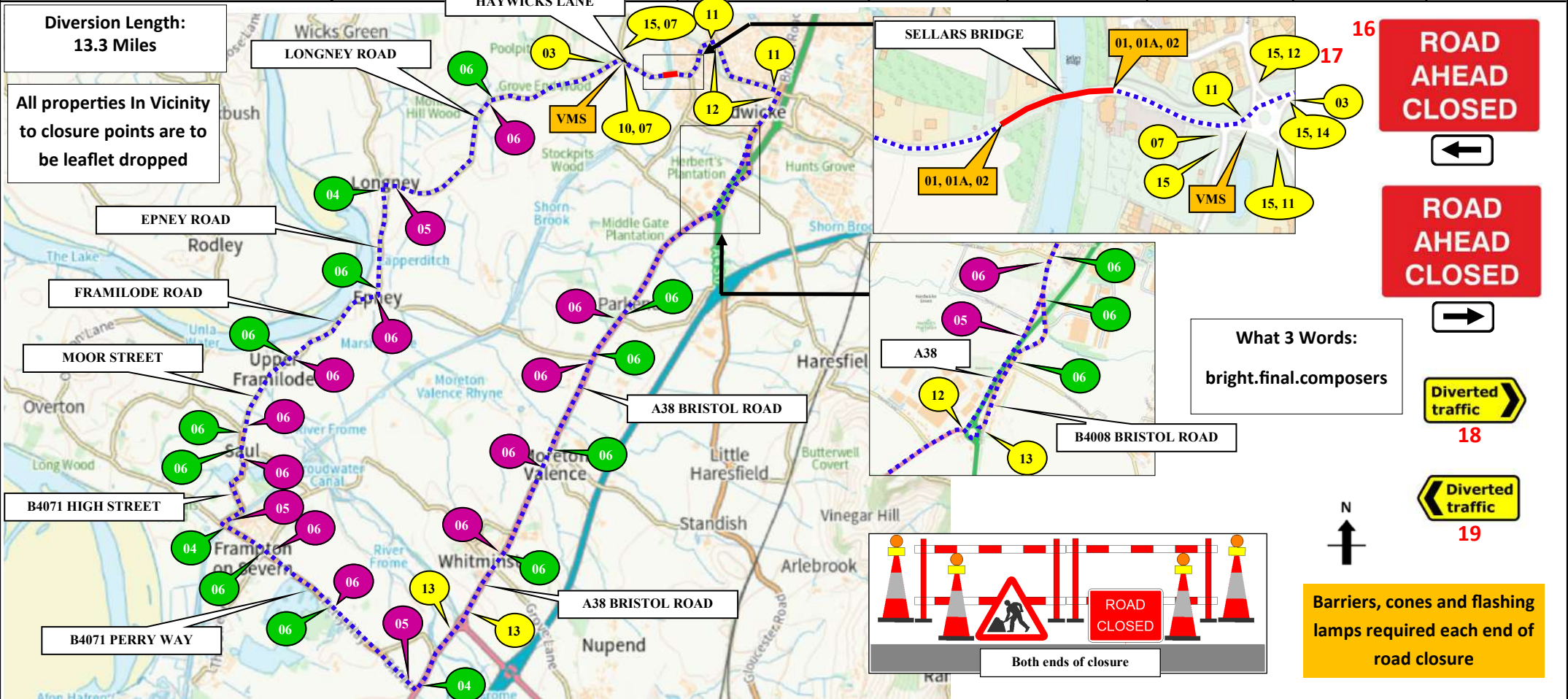

**SUNBELT RENTALS**

**Sunbelt Rentals UK (Traffic Management)**  
Kemble Airfield Enterprise Park  
Cirencester Road  
Kemble  
GL7 6BQ  
☎ 03700 500 792  
📠 0845 004 7105

Note

- All equipment shall be approved and shall comply with the Department Of Transport specification MCE0111. This drawing does not show the normal road works signage that will be required as per Chapter 8.
- All signs to be in accordance with TSRGD 2016 and to minimum class retroreflective.
- Minimum height of lettering to be 60mm and sign boards to be 1000mm (750mm where appropriate).

This drawing is protected by copyright and the information contained therein is confidential.  
This drawing may not be copied and the information therein may not be used, or disclosed to a third party, wholly or in part with the written permission of Sunbelt Rentals UK (Traffic Management).

CROWN COPYRIGHT DATA REPRODUCED BY PERMISSION OF THE CONTROLLER OF HMSO

<b>CLIENT DETAILS</b> Canal and River Trust		<b>REP/DEPOT</b> NB/213	<b>DRAWN BY</b> NB/213	<b>ADDRESS</b> Sellars Bridge, Hardwicke, Gloucester, Gloucestershire, GL2 4JE
<b>DATE</b> 09/04/2024	<b>SHEET No</b> 1 OF 1	<b>VERSION NUMBER</b> 001		
<b>AMENDED DATE</b>	<b>AMENDED BY</b>	<b>SCALE</b> NOT TO SCALE		
This layout is for installation by NRSWA, Lantra 12A,12B,,12D qualified persons.				
<b>BUS ROUTE AFFECTED</b>				

	ROAD CLOSURE		CLOCKWISE DIVERSION
	DIVERSION		ANTI-CLOCKWISE DIVERSION
			ROAD CLOSURE SIGN
<b>ROAD CLOSURE LENGTH (APPROX)</b>		130 M	
<b>ROAD CLOSURE WIDTH (APPROX)</b>		3.0 M	
<b>Contract Number 213-S015354</b>			